

- NOTES**
- DO NOT SCALE FROM THIS DRAWING.
  - ALL DIMENSIONS ARE IN METRES UNLESS OTHERWISE STATED.
  - THIS IS A PRELIMINARY DESIGN AND SHALL NOT BE USED FOR CONSTRUCTION.
  - THE HIGHWAY BOUNDARY INFORMATION SHOWN HAS BEEN TAKEN FROM HCC RECORDS & SHALL BE CONFIRMED ON SITE.
  - LIMITS OF WORK ARE APPROXIMATE AND ARE TO BE AGREED DURING NEXT PHASE OF DESIGN.
  - HEALTH AND SAFETY: THE CONTRACTOR SHALL BE AWARE OF ALL STATUTORY UNDERTAKERS PLANT THAT MAY BE LOCATED WITHIN THE SITE.
  - FOR PEDESTRIAN GUARD RAIL DETAILS, REFER TO HCC STANDARD DETAIL NO. HCC11/C/140
  - LOUVRES TO BE PROVIDED ON THE VEHICULAR TRAFFIC SIGNALS TO MINIMISE THE POTENTIAL RISK OF SEE-THROUGH.
  - FOR DRAINAGE DETAILS, REFER DRAWING NO. HCCSPCO-ATK-HDG-C541-DR-CD-000001 & 000002.
  - FOR PAVEMENT TYPICAL CROSS SECTIONS, REFER DRAWING NO. HCCSPCO-ATK-HPV-C541-DR-CH-000001.
  - FOR KERB, FOOTWAYS & PAVED AREA AND PAVEMENT DETAILS, REFER DRAWING NO. HCCSPCO-ATK-HGN-C541-DR-CH-000004 & 000005.
  - FOR ROAD MARKING AND SIGNS, REFER DRAWING NO. HCCSPCO-ATK-HSN-C541-DR-CH-000001 & 000002.
  - SIZE OF THE NEW COLUMN AND TYPE OF LUMINAIRE TO BE DETERMINED DURING DETAIL DESIGN.

**SAFETY, HEALTH AND ENVIRONMENTAL INFORMATION**

In addition to the hazards/risks normally associated with the types of work detailed on this drawing, note the following significant residual risks (Reference shall also be made to the design hazard log).

Construction
Live Traffic & Utilities Presence of soil contamination, asbestos, Hazardous tar and breaking of concrete not known.
Maintenance / Cleaning
None

Use
None

Decommissioning / Demolition
None

P06	SA/PP	AS	AC/DD	22.09.2021
Roundabout modifications excluded				
P05	SA/SR	AS	AC	14.07.2021
Preliminary Design Submission				
P04	SA/SR	AS	AC	07.07.2021
Central Island Modified				
P03	SA / SR	AS	AC	26.03.2021
Lighting Columns Added				
P02	SA / SR	AS	AC	05.02.2021
Preliminary Design Submission				
Rev	Drawn / Des	Checked	Approved	Date

Description	Drawn / Des	Checked	Approved	Date
Drawing Status	<b>FOR REVIEW / COMMENT</b>			Suitability
				<b>S3</b>

**ATKINS** County Gate, County Way  
Trowbridge, Wiltshire England  
BA14 7FJ  
United Kingdom

Tel: +44 (0)1225 730360  
Fax: +44 (0)  
www.atkinsglobal.com

Copyright © Atkins Limited (2019)

**Hampshire County Council** Engineering CONSULTANT

STUART JARVIS BSc DipTP FCIHT MTRPL DIRECTOR OF ECONOMY, TRANSPORT & ENVIRONMENT

Project Title  
**SOUTHAMPTON TCF - RUSHINGTON ROUNDABOUT (PRELIMINARY DESIGN)**

Drawing Title  
**GENERAL ARRANGEMENT (SHEET 1 OF 2)**

Scale	Designed / Drawn	Checked	Approved	Authorised
1:500	PP / SA	AS	AC/DD	
Original Size	Date	Date	Date	Date
A1	22.09.2021	22.09.2021	22.09.2021	
Drawing Number	Project	Originator	Volume	Job No.
HCCSPCO-ATK-HGN-C541-DR-CH-000001				5198364
Location	Type	Role	Number	Revision
				P06

- KEY**
- EXISTING HIGHWAY BOUNDARY
  - PROPOSED KERBLINE
  - PROPOSED CONCRETE EDGING
  - EXISTING PAVED AREA TO BE PLANED OUT & INLAID / OVERLAID WITH REGULATING COURSE
  - PROPOSED CARRIAGEWAY NEW CONSTRUCTION
  - PROPOSED SPLITTER ISLAND / FOOTWAY
  - PROPOSED VERGE / CENTRAL RESERVE
  - PROPOSED PEDESTRIAN GUARD RAIL
  - PROPOSED TRAFFIC SIGN
  - PROPOSED TRAFFIC SIGNAL (INDICATIVE)
  - PROPOSED LIGHTING COLUMN
  - BOUNDARY OF THE SITE

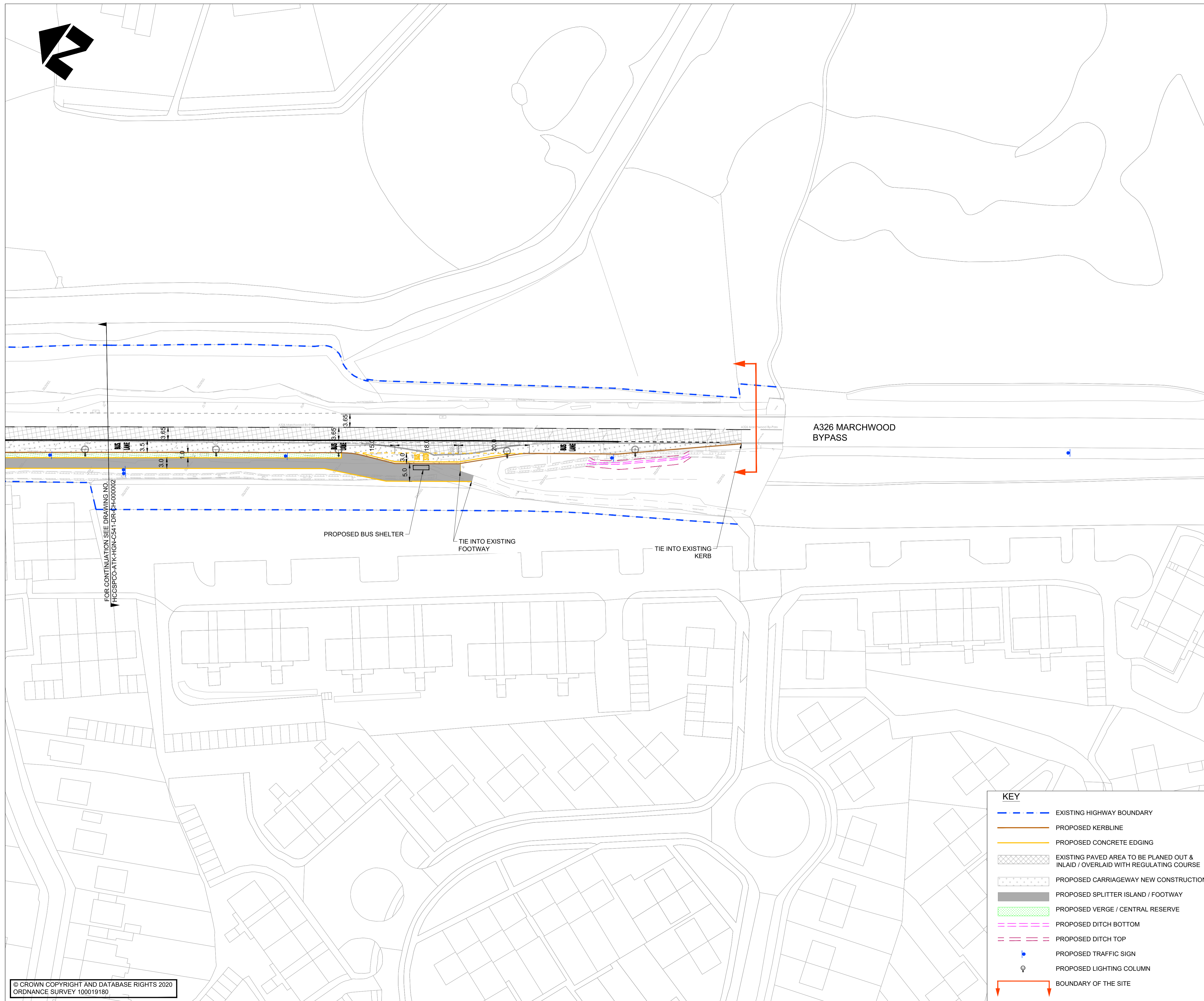
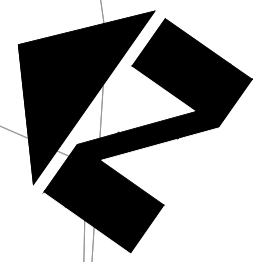

- NOTES**
- DO NOT SCALE FROM THIS DRAWING.
  - ALL DIMENSIONS ARE IN METRES UNLESS OTHERWISE STATED.
  - THIS IS A PRELIMINARY DESIGN AND SHALL NOT BE USED FOR CONSTRUCTION.
  - THE HIGHWAY BOUNDARY INFORMATION SHOWN HAS BEEN TAKEN FROM HCC RECORDS & SHALL BE CONFIRMED ON SITE.
  - LIMITS OF WORK ARE APPROXIMATE AND ARE TO BE AGREED DURING NEXT PHASE OF DESIGN.
  - HEALTH AND SAFETY: THE CONTRACTOR SHALL BE AWARE OF ALL STATUTORY UNDERTAKERS PLANT THAT MAY BE LOCATED WITHIN THE SITE.
  - FOR PEDESTRAIN GUARD RAIL DETAILS, REFER TO HCC STANDARD DETAIL NO. HCC11/C/140
  - LOUVRES TO BE PROVIDED ON THE VEHICULAR TRAFFIC SIGNALS TO MINIMISE THE POTENTIAL RISK OF SEE-THROUGH.
  - FOR DRAINAGE DETAILS, REFER DRAWING NO. HCCSPCO-ATK-HDG-C541-DR-CD-000001 & 000002.
  - FOR PAVEMENT TYPICAL CROSS SECTIONS, REFER DRAWING NO. HCCSPCO-ATK-HPV-C541-DR-CH-000001.
  - FOR KERB, FOOTWAYS & PAVED AREA AND PAVEMENT DETAILS, REFER DRAWING NO. HCCSPCO-ATK-HGN-C541-DR-CH-000004 & 000005.
  - FOR ROAD MARKING AND SIGNS, REFER DRAWING NO. HCCSPCO-ATK-HSN-C541-DR-CH-000001 & 000002.
  - SIZE OF THE NEW COLUMN AND TYPE OF LUMINAIRE TO BE DETERMINED DURING DETAIL DESIGN.

**SAFETY, HEALTH AND ENVIRONMENTAL INFORMATION**

In addition to the hazards/risks normally associated with the types of work detailed on this drawing, note the following significant residual risks (Reference shall also be made to the design hazard log).

Construction	Presence of soil contamination, asbestos, Hazardous tar and breaking of concrete not known.
Maintenance / Cleaning	None

Use  
None

Decommissioning / Demolition  
None

P05	SA/SR	AS	AC	14.07.2021
Preliminary Design Submission				
P04	SA/SR	AS	AC	07.07.2021
Central Island Modified				
P03	SA / SR	AS	AC	26.03.2021
Lighting Columns Added				
P02	SA / SR	AS	AC	05.02.2021
Preliminary Design Submission				

Rev	Drawn / Des	Checked	Approved	Date
Description				

Drawing Status: **FOR REVIEW / COMMENT** Suitability: **S3**

**ATKINS** County Gate, County Way  
Trowbridge, Wiltshire England  
BA14 7FJ  
United Kingdom

Tel: +44 (0)1225 730360  
Fax: +44 (0)  
www.atkinsglobal.com

Copyright © Atkins Limited (2019)

**Hampshire County Council** Engineering CONSULTANT

STUART JARVIS BSc DipTP FCIBT MIRTP: DIRECTOR OF ECONOMY, TRANSPORT & ENVIRONMENT

Project Title  
**SOUTHAMPTON TCF - RUSHINGTON ROUNDABOUT (PRELIMINARY DESIGN)**

Drawing Title  
**GENERAL ARRANGEMENT (SHEET 2 OF 2)**

Scale	1:500	Designed / Drawn	SR / SA	Checked	AS	Approved	AC	Authorised	
Original Size	A1	Date	14.07.2021	Date	14.07.2021	Date	14.07.2021	Date	
Drawing Number	Project		Originator	Volume		Job No.		Revision	
	HCCSPCO-ATK-HGN-C541-DR-CH-000001					5198364		P05	
Location	Type	Role	Number						

**KEY**

- EXISTING HIGHWAY BOUNDARY
- PROPOSED KERBLINE
- PROPOSED CONCRETE EDGING
- EXISTING PAVED AREA TO BE PLANED OUT & INLAID / OVERLAID WITH REGULATING COURSE
- PROPOSED CARRIAGEWAY NEW CONSTRUCTION
- PROPOSED SPLITTER ISLAND / FOOTWAY
- PROPOSED VERGE / CENTRAL RESERVE
- PROPOSED DITCH BOTTOM
- PROPOSED DITCH TOP
- PROPOSED TRAFFIC SIGN
- PROPOSED LIGHTING COLUMN
- BOUNDARY OF THE SITE

© CROWN COPYRIGHT AND DATABASE RIGHTS 2020  
ORDNANCE SURVEY 100019180